

SECURITHERM thermostatic basin mixer

Ref. H9600610

Single hole thermostatic sequential mixer, H. 95mm L. 120mm

DESCRIPTION

SECURITHERM thermostatic basin mixer - Ref. H9600610

Deck-mounted SECURITHERM thermostatic basin mixer.
Thermostatic sequential mixer: opens and closes with cold water.
No risk of cross flow between hot and cold water.
No non-return valve on the inlets.
Anti-scalding failsafe: shuts off automatically if cold or hot water supply fails.
Securitouch thermal insulation prevents burns.
Single hole mixer with straight spout H. 95mm L. 120mm fitted with a hygienic flow straightener for no impurity retention and resistance to thermal shocks.
Scale-resistant thermostatic sequential cartridge for single control of flow rate and temperature.
Temperature can be adjusted from cold water up to 40°C with maximum temperature limiter set at 40°C.
Thermal and chemical shocks are possible.
Body and spout with smooth interiors and low water volume.
Flow rate limited to 5 lpm at 3 bar.
No manual contact thanks to Hygiene control lever L. 146mm.
No pop-up waste.
Supplied with copper tails and stopcocks in chrome-plated brass.
Fixing reinforced by 2 stainless steel rods.
Mixer ideal for healthcare facilities, retirement and care homes, hospitals and clinics.
Mixer suitable for people with reduced mobility.
30-year warranty.
Also available with PEX flexibles.

TECHNICAL CHARACTERISTICS

SECURITHERM thermostatic basin mixer - Ref. H9600610

Connector	M1/2" Ø 15mm
Technology	SECURITHERM Securitouch sequential mixer
Drop height	95mm
Spout length	120mm
Flow rate	5 lpm
Temperature limiter	Yes
Finish	Chrome-plated brass
Norms	



ADVANTAGES



Sequential: opens/closes with cold water



Maximum hygiene: no non-return valves



SECURITHERM: optimal anti-scalding safety



Securitouch: thermal insulation prevents burns

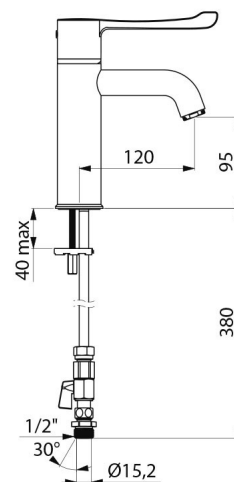

Warranty



Repairability

