

# BIOSAFE mechanical basin mixer

Ref. 2621

Single hole mechanical mixer with no spout, H. 95mm L. 110mm

## DESCRIPTION

**BIOSAFE mechanical basin mixer - Ref. 2621**

Deck-mounted mechanical basin mixer.  
Single hole mechanical mixer H. 95mm L. 110mm.  
No spout: hygienic flow straightener integrated into the body.  
Securitouch thermal insulation prevents burns.  
Ø 35mm ceramic cartridge with pre-set maximum temperature limiter.  
No risk of cross flow between the hot and cold water.  
No non-return valves on the inlets.  
Thermal shocks are possible without removing the control lever or shutting off the cold water supply.  
Mixer body with smooth interior and very low water volume (limits bacterial development).  
Flow rate set at 4 lpm.  
Solid control lever.  
No pop-up waste.  
PEX flexibles F3/8", rotating unions.  
Fixing reinforced by two stainless steel rods.  
Mechanical mixer ideal for healthcare facilities, retirement and care homes, hospitals and clinics.  
Single hole mixer suitable for people with reduced mobility.  
Mixer with 30-year warranty.  
Also available with copper tails.

## TECHNICAL CHARACTERISTICS

**BIOSAFE mechanical basin mixer - Ref. 2621**

Connector	F3/8"
Technology	BIOSAFE mechanical mixer
Height	180mm
Length	220mm
Drop height	95mm
Spout length	110mm
Flow rate	4 lpm
Temperature limiter	Yes



## ADVANTAGES



Hygiene: body with very low water volume



Maximum hygiene: no spout



Thermal shocks are possible



Pre-set maximum temperature limiter

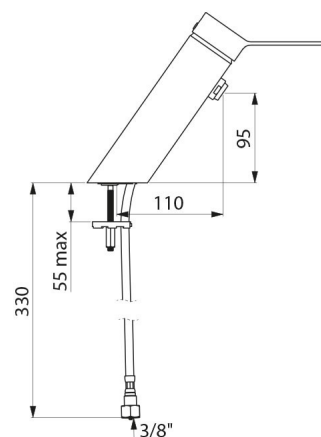

Norms

ACS

NF

WRAS

DVGW

Water Supplies Department

B

BSI

Warranty	
Repairability	